

# ECO-FUN IN TAIPEI



# ECOLOGY



The greater the challenge, the greater the points! Let's color the hearts according to your preference of the attraction!

Add up your scores at inside of back cover

Q After browsing this brochure, what are some of the places you'd like to take on? (Write down the codes below)

→ → → → → → →  
→ → → → →

Taipei is an energetic city with abundant natural resources. Let's explore a different side of Taipei!

- BR Wenzhu Line
- R Tamsui-Xinyi Line
- G Songshan-Xindian Line
- O Zhonghe-Xinlu Line
- BL Bannan Line
- A Taoyuan Airport MRT

- Flower
- Butterfly
- Bird
- Firefly
- Frog
- View



# TRANSPORTATION GUIDE



## MRT

The Taipei MRT consists of the Wenhua Line, Tamsui-Xinyi Line, Songshan-Xindian Line, Zhonghe-Xinlu Line, and Bannan Line. It's a quick and convenient transportation. Apart from using the EasyCard or iPass for ticket fares, the Taipei MRT provides several travel passes, all of which can fulfill your traveling needs.



## Bike

You only need to use your EasyCard or iPass to rent the massively convenient, 24-hour YouBikes which are well situated throughout the city at any one of the concentrated YouBike stands. The Riverside Bike Rental Centers along the Tamsui river bikeways have a rental service where you can pick up a bike at one stop and return it at another.

☎ (02)218-12345 (24 Hours Service)

🕒 06:00-24:00



### YouBike:

☎ (02)8978-5511

🕒 24-hour

### Riverside Bike Rental:

☎ (02)2258-7425

🕒 Please check the official website.

### YouBike



### Riverside Bike Rental



## EasyCard & iPass

Cards can be bought at MRT stations, convenience stores, and other designated shops. After topping up, you can use it to take public transport and rent the YouBike. Also, you can use it as an e-wallet at convenience stores and specific shops for micropayment.



## Taipei MRT Ticket



### Single-Journey

NT\$20-65



### 1 day

NT\$150



### 24hr Pass

NT\$180



### 48hr Pass

NT\$280



### 72hr Pass

NT\$380

Taipei is a city with a quick and convenient mass-transit system comprised of the MRT, sightseeing buses, bike rentals, and taxis, etc. Travelers can pick the most suitable methods and easily flit around Taipei.



### Sightseeing Bus

Taipei Sightseeing Bus has two routes: Red and Blue. Both lines start at Taipei Main Station. The red line runs in a loop between several tourist attractions in the city center, e.g. Longshan Temple, Yongkang Shopping District, Taipei 101 and Huashan 1914 Creative Park. The blue line goes to Ximending, the Taipei Fine Arts Museum, Shilin Night Market, the Shilin Official Residence, the National Palace Museum and other sites.



### Taxi

Yellow taxi cabs of Taipei can pick you up and take you wherever you'd like. With high mobility, taxi is a great choice for getting you where you need to go. The current daytime fare for taxis starts from NT\$70 and add another NT\$20 for late night surcharge from 23:00 to 06:00.

(02)8791-6557 ext. 30



## Types of Ticket



### Taipei Fun Pass

When travelling in Taipei City, New Taipei City, and Keelung City, visitors can choose one of the following cards according to their needs.



#### Exploring Version

Tickets to 20 tourist spots  
+  
Stored-value EasyCard function



#### Unlimited Version

Tickets to 16 tourist spots  
+  
Unlimited use of Taipei MRT, public buses, and 5 Taiwan Tourist Shuttle routes



#### Transportation Version

Unlimited use of Taipei MRT, public buses, and 5 Taiwan Tourist Shuttle routes; 1-, 2-, 3-, and 5-day cards and 1-day Maokong Gondola card available



# 01

## CYCLING

Going by bike is a relaxing, eco-friendly and healthy way of traveling. 7 cycling destinations are included in this chapter for you to enjoy the breeze and explore nature in Taipei.

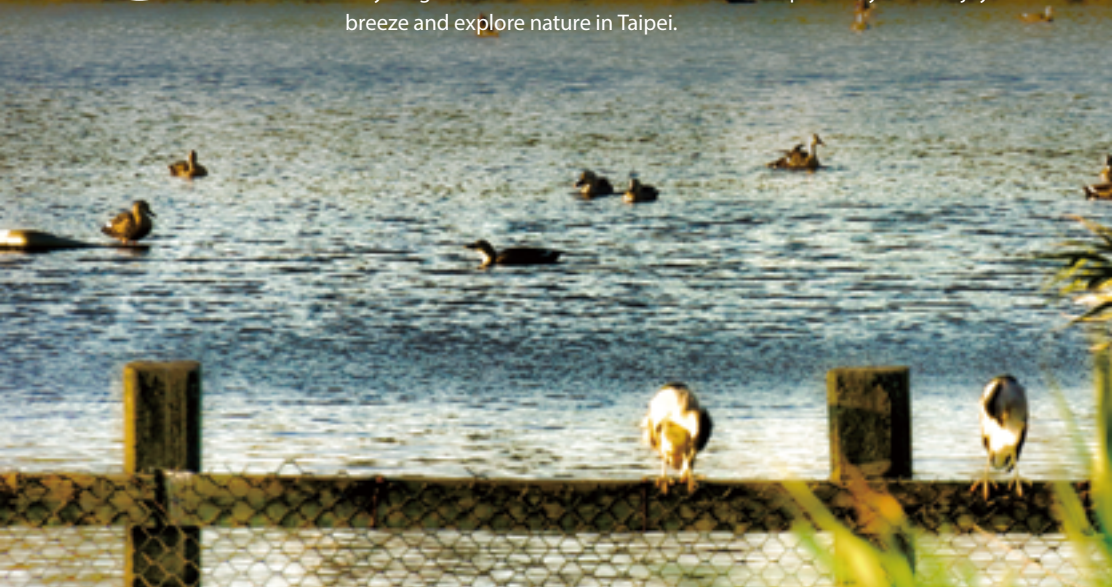

### 1 **Huajiang Wild Duck Nature Park**

*By Tamsui Riverside (Between Huajiang Bridge and Guilin Rd.)*

+10  
♡♡♡♡♡

This park is one of the most popular bird-watching spots in Taipei. Every year from September through April, throngs of birds coming from Siberia and Northeast Asia winter here. Presently, thousands of birds including more than 90 species can be spotted within the park annually during winter, and most of them are anatidae and charadriidae.

Owing to the sedimentation of the Tamsui River, a large area of wetland is formed here. The wetland soil contains rich nutrients and organic matter, and this can nourish a member of a agnatic plants like reeds, Narrow-leaved Cattail, fishes and shrimps, which make the wetland an idea habitat for birds.

Iconic residents of the area are the Green-winged Teal and Eastern Spot-Billed Duck. Grey Herons, Little Ringed Plovers, and other

waterfowls are frequent visitors to this wetland park.

In order to facilitate the observation of the birds and the natural environment, the park constructed a 600-meter long pathway with explanatory plaques along the path. Volunteers of the Wild Bird Society of Taipei also offer professional guide tours for visitors every Sunday. Aside from bird watching, the river bikeway is also a good idea for visitors who would like to relax and take in the wetland scenery.

#### **BIKE RENTAL:**

**YouBike:** MRT Longshan Temple Sta. (Exit. 1), Huaxi Park, Longshan Elementary School

**Taipei Riverside Bike Rentals:**  
Dadaocheng Station (Beside  
Dadaocheng Wharf)

Location





Taken in Guandu Nature Park



## Guandu Nature Park



55, Guandu Rd., Taipei City

Guandu Nature Park is a precious wetland area located in northern Taiwan, as well as an excellent site for bird-watching. At present, one can catch sight of 299 species of birds here. Every year, from September to April, various species of migratory birds spend the winter here. One of the most commonly sighted birds is the Black-winged Stilt. Other species include the Green-winged Teal, Common Greenshank, Gray Heron, and Great Egret. Black-Faced Spoonbill is another seldom-sighted winter visitor.

In addition to using the high-magnification spotting scope on the second floor of the Visitor Center to see the birds inhabiting Core Reserve Area, visitors can observe wildlife at several themed areas. There are also free professional tours conducted by volunteers, which offer deeper insights into the park. For overview of the entire park, Guandu river bikeway is your best choice. You can see water birds flying around and foraging, as well as the mangrove, which nourish the area's wildlife and quietly protect the habitat of these birds.

### BIKE RENTAL:

**YouBike:** MRT Guandu Sta., Guandu Nature Park, Kuantu Temple

**Taipei Riverside Bike Rentals:** Guandu Station (Beside Guandu Wharf)

Location



### Guizikeng Soil and Water Conservation Classroom



161, Xiushan Rd., Taipei City

About 6 km from Guandu Nature Park is a natural geological classroom that is worth a visit. Planned geological observation trail, weather observation stations and soil and water conservation teaching tools are set up for the visitors to gain insight on geology and the park's nature lives.



#### BIKE RENTAL:

**YouBike:** Shezi Elementary School, Shezi Park, Fu-an Junior High School

#### Location



Shezidao is a sandbar situated at the intersection of the Keelung and Tamsui River. Shezidao Bikeway is flat and offers beautiful views of both the Datun Mountains and Mt. Guanyin from the sides of the course. Bikers can also see the crystalline waters of the Keelung River and the abundant wildlife of the Shezidao wetlands.

The natural wetlands: Shezidao, Daotou and Sheliu are ideal for bird-watching. More than 40 kinds of birds can be spotted all year round. In addition to the Crested Myna endemic to Taiwan, Egrets, Black-eared Kites, Ospreys and Common-winged Teals are often seen. Migratory birds like Common Greenshanks and Cattle Egrets visit the wetlands every March and April. During this time of the year, visitors might even have the chance to observe the endangered Black-faced Spoonbill and Eurasian Spoonbill.

In addition, Daotou Park at the northern tip of Shezidao is a great place to enjoy the scenery. Besides the scenic riverbank, you can also see the mangrove and the traces of fiddler crabs at ebb tide.



Photo : Hydraulic Engineering Office, Taipei City Government





4

**Daan Park***1, Sec. 2, Xinsheng S. Rd., Taipei City*

+5

As an ecological park with a forest-like environment in central Taipei, Daan Park is usually regarded as the "lungs of Taipei." Thanks to the efforts of the community and the government, Yellow-edged Fireflies have been successfully brought back to Daan Park. Every year in April and May, glowing fireflies flutter through the air and light up the ecological ponds.

Location



5

**Fuyang Eco Park***At the end of Fuyang St., Taipei City*

+5

The park retains its low-altitude forest ecosystem. Today there are more than 331 varieties of plants growing here, and various species of insects, butterflies, birds, frogs and other animals, such as Swinhoe's Tree lizards, Black-naped Monarchs and skipper butterflies can all be found in this exceptional place.

Location



6

**Taipei Botanical Garden***53, Nanhai Rd., Taipei City*

+5

The Taipei Botanical Garden serves as an important institution for the classification and preservation of plants. More than 1,200 plant species are displayed within the garden, e.g. ferns and fern allies, ginger plants, and you can see lotuses in full bloom in the pond during summer. Additionally, more than 90 bird species can be seen here, making this place a popular spot for birdwatching.

Location



7

**CKS Shilin Residence Park***60, Fulin Rd., Taipei City*

+5

The CKS Shilin Residence Park has a garden planted with more than 100 varieties of roses, making it a wonderful place for flower lovers. The Chrysanthemum Show is held at the end of every November. The highlight of the show are the "Da-li Chrysanthemums," which are composed of hundreds of flowers of the exact same size. This is a must-see if you visit the residence in late fall.

Location



# 02



## HIKING

With mountains on three sides and a convenient, well-developed mass-transit system, you can take it easy, wander in the mountains nearby and be embraced by forest. Let's go trekking and discover the natural beauty of Taipei !

### 1 Four Beasts Mountains Hiking Trails

*Aly. 22, Ln. 150, Sec. 5, Xinyi Rd., Taipei City  
Ln. 251, Fude St., Taipei City*

Situated in the southeast of Taipei, Xiangshan (Elephant Mountain), Shishan (Lion Mountain), Baoshan (Leopard Mountain) and Hushan (Tiger Mountain) gained their names from their formations resembling the shapes of their corresponding animals, and are collectively called the "Four Beasts Mountains." The relatively flat terrain of the mountains are enjoyable for people of all ages. It is recommended to enter the trails from Xiangshan or Hushan Hiking Trail as they are close to Xinyi Shopping District and offer a fantastic view of the Taipei basin, Taipei 101, and nearby mountains.



**Xiangshan Hiking Trail**

Xiangshan Hiking Trail is a popular hiking destination for its convenient location, great public transportation and clear direction signs along the trail. The trail starts at Lingyun Temple near MRT Xiangshan station and divides into a fork shortly after. Go left at the fork for the flatter Yixiantian (Single Line Sky) trail and see massive monoliths, cliffs, narrow boulder crevices and other natural wonders. The right fork leads you up to a steep stone stairway; in the middle of the trail sits Liujushi (Six Boulders), a towering set of six giant rocks and the best spot to see the city's night scenery.

The mountain hosts an abundant array of wildlife, including frogs, butterflies and birds. For instance, Taipei Tree Frogs and other endemic frogs can be found, as well as butterflies like the swallowtail and nymphidae,

joined by Taiwan Blue Magpies and Taiwan Barbets. A plethora of ecological treasures awaits discovery.

**Hushan Hiking Trail**

Hushan Creek Hiking Trail is great for ecological exploration; ferns and fern allies thrive in the humid environment resulting from the mountain creek. The mountain boasts over 70 species of ferns, including the Spiny Tree Fern and the Maidenhair Fern. Creek fishes like groupers and gobies populate the mountain creeks. In April and May, the area becomes a paradise for fireflies, and visitors are able to observe Black-Winged Fireflies fluttering about at night.

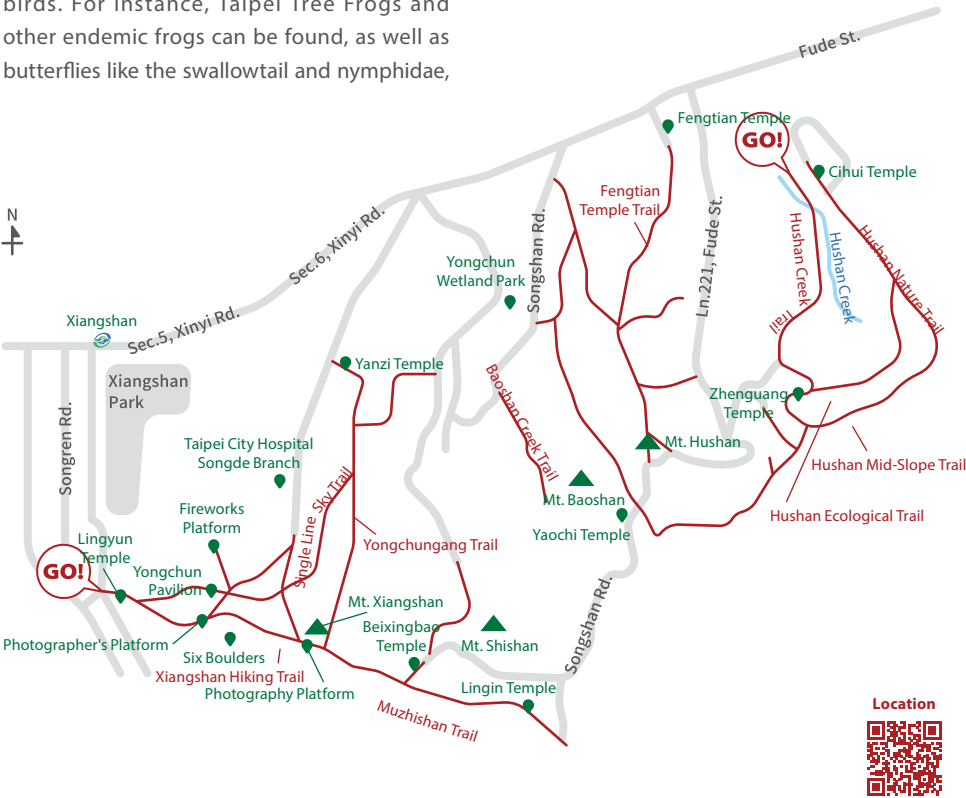



## Maokong Hiking Trails

Sec. 3, Zhinan Rd., Taipei City



+10



Maokong, one of northern Taiwan's important tea-growing areas, is known internationally for its Tieguanyin and Wenshan Baozhong tea. Coming here, visitors can soak in the aroma and scenery of the tea garden, or stroll along Zhangshu and Zhanghu Trails for rural and wildlife landscape. Another specialty visitors might enjoy is the potholes carved out by the running water of creeks nearby.

### Special Geological Landscape - Potholes

Pothole landscape is an extraordinary natural wonders which visitors should not miss in Maokong. These round-shaped holes on the riverbed are the result of river erosion. To get full view of potholes, the Pothole Rope Bridge would be the wonderful viewing spot, where you can look down and see the geological formations through the clear creek water. If you're afraid of crossing the rope bridge, a nearby observation deck is at your service.

### Zhangshu Trail

This trail lies close to the Maokong Gondola Station. The 1.2 km walk is moderate, and rural properties such as tea gardens, bullock carts, barns and farm ponds are along the path. In addition, visitors can see lovely lupines come into full bloom from February to April, adding even more colors to the trail. As night descends, endemic Taipei Tree Frog, Emerald Green Tree Frog, Ornate Ricefrog, and Latouchte's Frog begin their harmonious symphony, turning the evening into an outdoor concert.

### Zhanghu Trail

The semicircular Zhanghu Trail serving as the main thoroughfare between Maokong and down town in the past, connects Zhangshu Trail to form a loop. Spring and summer are primetime for the acacia tree blossoming.

The "Melody Gallery" is another feature of the Zhanghu Trail. The installations are almost made from natural materials. The interactive musical instruments intrigue visitors to stop by and create their own music.







Location



Photo : Geotechnical Engineering Office, Taipei City Government



### 3 Jiantanshan Hiking Trail 🐦 🏔️ Liyushan Hiking Trail 🐦 🦋

Nearby Bus Jiantan st., Sec. 4, Zhongshan N. Rd., Taipei City  
Middle Section of Ln. 131, Dahu St., Taipei City

+10  
♥♥♥♥♥♥♥♥

Jiantanshan Hiking Trail is only a short walk from MRT Jiantan station. The slope of the trail is gentle. The 10 unique sceneries of Yuanshan Scenic Area can be seen when people pass by the trail, which is suitable for visitors of all ages. At the end of the trail, there is Jiannan Butterfly Eco-education Park which is a must see for butterfly lovers. As visitors walking down Jiannan Rd., they will pass through a verdant corridor formed by Mt. Jinmian and Liyu.

#### Jiantanshan Hiking Trail

Mt. Jiantan is a part of the Wuzhi Mountain Range, one of the top 100 peaks of Taiwan. As a former military restriction area, the floristic composition of Mt. Jiantan is well-reserved and varied: the forest is comprised of Red Machilus, Incense Machilus, and Common Elaeocarpus, while below them are Psychotria Rubra and Red Wild Coffee. These plants create an area highly suitable for habitation and foraging for many animals. For example, you might see Taiwan Blue Magpies or Taiwan Barbets along Yuanshan Scenic Area.

In addition to learning about local history from the military sentry boxes remnant located along the trail, you can also get a sweeping view of the Taipei basin and Mt. Guanyin scenery from lookout platforms. There is no better place to view the scenery than “Laodifang (The Old Place)” the most famous spot on Mt. Jiantan. Here you can get a bird's eye view of planes taking off and landing at Taipei Songshan Airport, and admire the scenery of Dajia riverside park, the Keelung River, and Taipei 101.

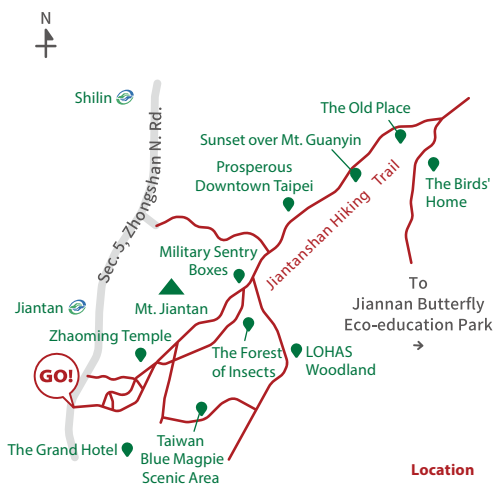

Location



#### Jiannan Butterfly Eco-education Park 🦋

With plantings of various endemic species of honey plants, the park creates a natural habitat and over 150 species of butterflies can be found here. Accordingly, this park is unsurprisingly an excellent place for butterfly-watching in Taipei.



Taken in Jiantanshan

## Liyushan Hiking Trail

The entrance to Liyushan Hiking Trail is located near the Yeh's family ancestral temple next to MRT Dahu Park station. Visitors may turn left for Liyushan Hiking Trail and turn right to Yuanjue Temple Trail. These two trails are connected as a loop.

Strolling along Yuanjue Temple Hiking Trail, you may see Taiwan Whistling Thrushes and Common Kingfishers foraging near the Dagou Creek. If the weather is clear, you can see swallowtails, nymphalidae and dragonflies dancing about. Returning from the Liyushan Hiking Trail, pay attention to the ground and you will find yourself surrounded by miniature models of famous attractions like Presidential Office as if Gulliver does in Lilliput.

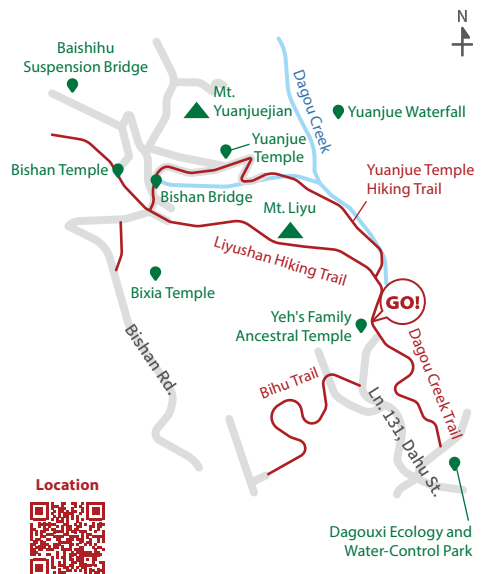



Photo : Geotechnical Engineering Office, Taipei City Government



+15



## 4 Yangmingshan National Park



Shihlin Dist., & Beitou Dist., Taipei City

Yangmingshan National Park, mainly consists of the Datun Volcano Group, has an ecosystem full of abundant flora and fauna. In early spring, cherry and azalea blossoms cover the mountains, while on the cusp between spring and summer, you can see blooming calla-lilies and hydrangeas gently blowing in the breeze. The park is your top choice to savor the view of extraordinary geological landscapes, vast grasslands and assorted beautiful flowers.

### Trails of Zhuzihu

Hiking along the trails of Zhuzihu, not only can you enjoy the beautiful scenery of flowers blooming, you can also have an amazing experience picking calla-lilies and hydrangeas. Looking around, you can see the mist rising from the faraway Xiaoyoukeng and egrets foraging in the fields. Among trails in Zhuzihu area,

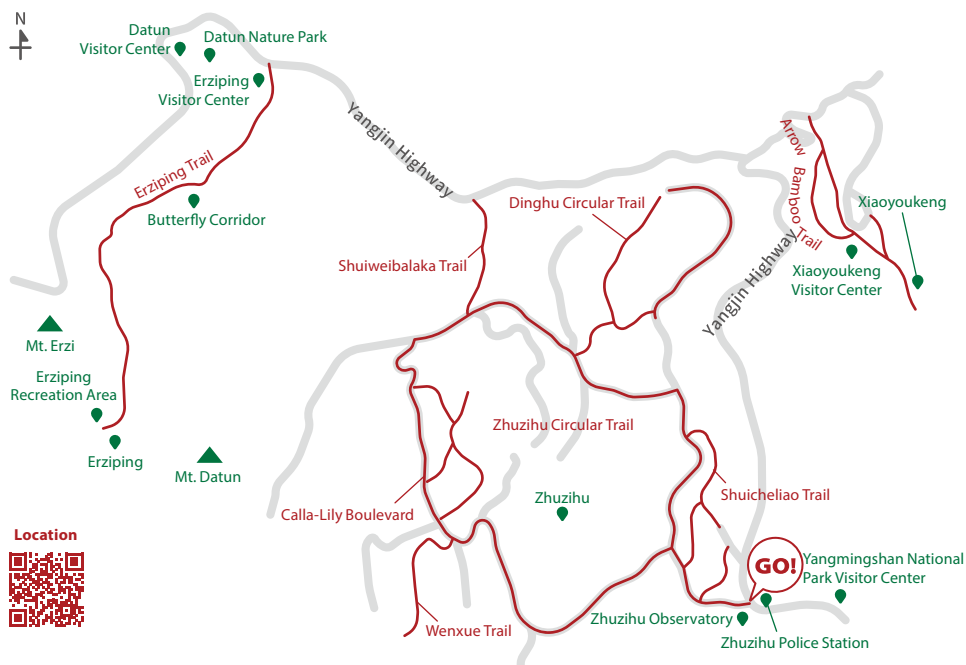

Shuicheliao Trail is particularly noteworthy, as Japonica rice was first cultivated in the area. A visit to the mountainous Zhuzihu area relieves you of the stress and tensions of daily life.

### Erziping Trail

Erziping, where a 1.8 km trail is constructed, is the valley between Mt. Erzi and the main peak of Mt. Datun. A wide variety of plants flourish along the trail, e.g. Red Machilus, Common Eurya, and Formosan Begonias. In summer, when honey plants are blossoming, you can see Blue Tiger Butterflies, Oakleaf Butterflies, Indian Fritillaries and other butterflies, which is the reason for the trail also being called the "Butterfly Corridor."

Continuing along the trail, you will reach the Erziping Recreation Area. The eco pond here is home to Taipei Tree Frogs, Latouchte's Frogs and Long-Legged Frogs, as well as several different aquatic plants.

### Xiaoyoukeng and Arrow Bamboo Trail

Xiaoyoukeng is another popular tourist site in Yangmingshan. At Xiaoyoukeng, you can observe spectacular scenery of the eruption of steam and sulfurous gases from the fumaroles; hot springs and sulfur crystals can be viewed in the surrounding area as well.

If you want to get a full view of Xiaoyoukeng and silver grass swaying in the wind, you should not miss the nearby "Arrow Bamboo Trail." Two viewing platforms are set up on the trail, and offer great views of Mt. Datun, Mt. Xiaoguangyin and the Zhuzihu area.





## Qingtiangang Circular Trail

Hiking along the Qingtiangang Circular Trail, you can see the remains of the "Jinbaoli Gate" and many historic trails hidden in the woods.

But the most famous spot at Qingtiangang is the vast grassland. Since it was used as a cow pasture, you can see water buffalo munching on grass; and sometimes there's even Crested Serpent-Eagles circling overhead. The view of faraway mountains lay right before your eyes, and it feels like a dreamland as clouds and mist rolls in.

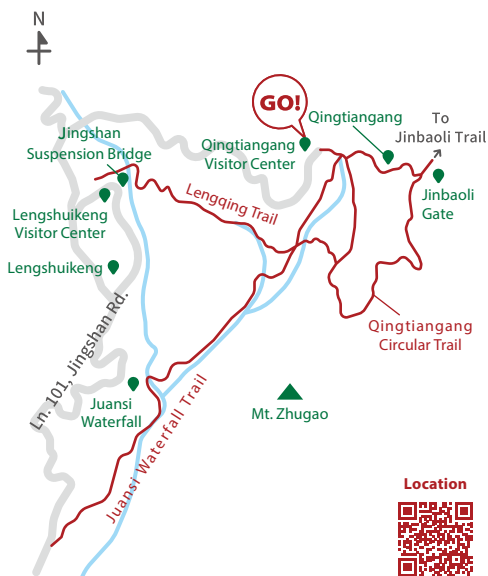



## LET US DO IT TOGETHER!

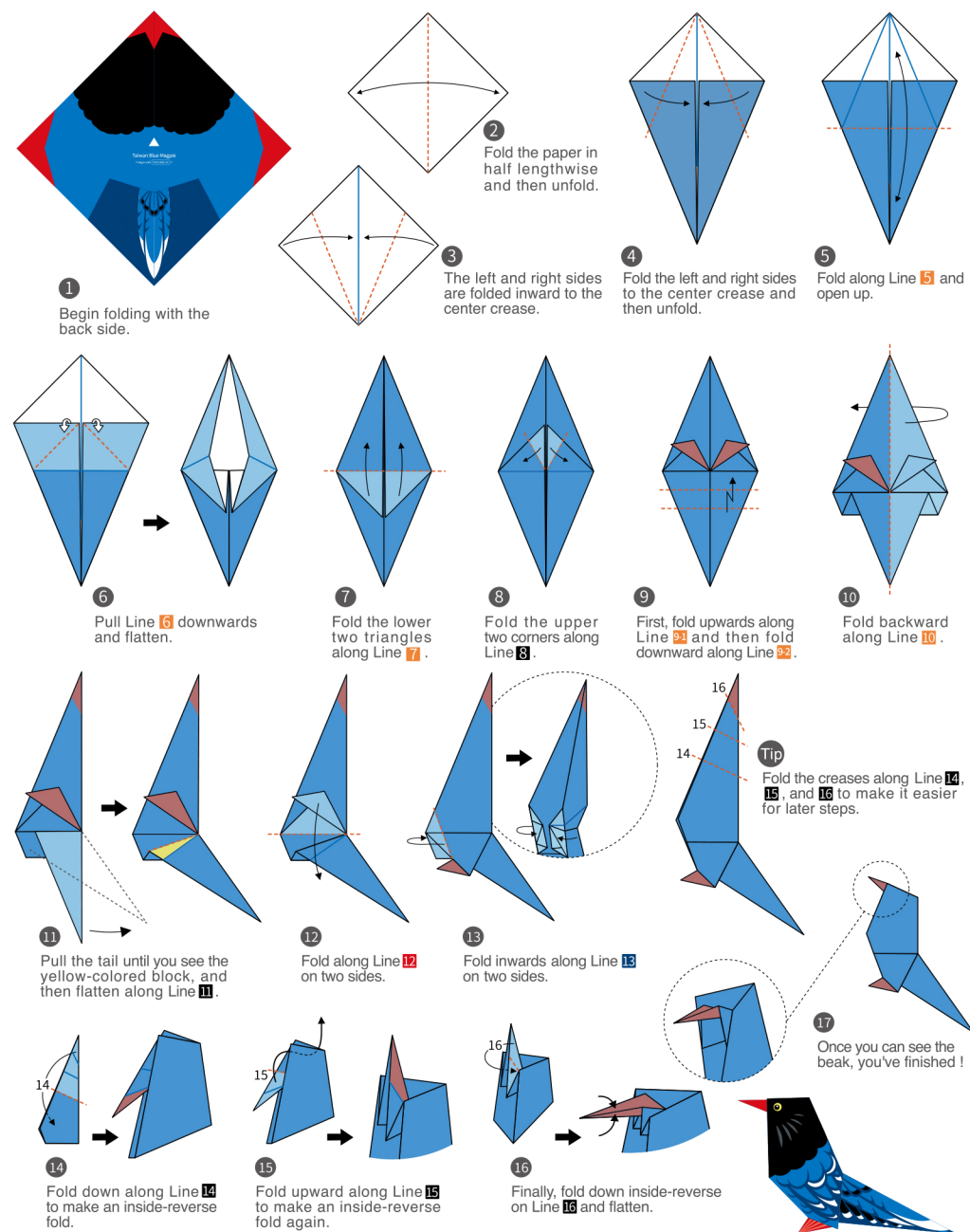

## THE TAIWAN BLUE MAGPIE

The Taiwan Blue Magpie, also the city bird of Taipei, is a protected species endemic to Taiwan. The Taiwan Blue Magpie has a black head, vermilion beak, regal blue body and gorgeous white tail-feathers, thereby earning it the nickname "long-tailed lady of the mountains." When they glide through the air, their elegant figure always strikes people with awe.

Moreover, the Taiwan Blue Magpie can be regarded as an indication of the island's low-altitude forests. If they can be seen frequently, it means that the forest is well-conserved. Besides, the Taiwan Blue Magpies usually live in small groups and closely follow one another when flying between trees and over valleys.

In recent years, one can see the Taiwan Blue Magpies not only in Taipei's neighboring boroughs such as the Taipei Zoo and Yangmingshan, but also in the city center. If you want to stick the charming figure of this avian beauty in your memory, try to make a paper one with your hands.

the sound of bird



Taiwan Blue Magpie  
< Begin with THIS SIDE UP >

## NOTICE



### Firefly watching

No Catching. No Disturbing.  
No lighting the fireflies directly.  
Use red cellophane to cover flashlights to avoid disturbance.



### Bird watching

Wear plain clothing.  
Keep quiet.  
Keep a distance.



### Butterfly watching

Do not enter into overgrown areas.  
No Catching.  
Keep a distance.

\* The information of this brochure is for reference only. Please check official website before you visit.

## Eco-challenge Score



Have you finished your challenges?  
Add up your points and see what title you've earned!

0~25 Eco-rookie

51~75 Eco-adventurer

26~50 Eco-observer

76~100 Eco-master

SCORE

/100 pt

DATE

# Taipei MRT Map



## Legend

BR Wenhu Line

R Tamsui-Xinyi Line

G Songshan-Xindian Line

O Zhonghe-Xinlu Line

BL Bannan Line



- Line Color
- Regular Station
- Station No.
- Transfer Station
- Terminal Station
- Airport
- HSR
- TRA
- Taoyuan Airport MRT
- Danhai LRT
- Passage
- Visitor Information Center
- Mobile Visitor Information Service

觀光傳播局

undiscovered  
taipei



※To the best of our knowledge, the information contained herein is correct as of date of publication; in case of changes, the information announced by individual business takes precedence.

※It is possible to apply for the copyright of this publication. Please scan this QR code.

Aug. 2019 Published

AD